

DUBAI CREEK HARBOUR

CREEK BEACH

ROSEWATER

AES
REAL ESTATE
STAY AHEAD, INVEST SMART

db
DUBRICKS
POSSIBILITIES ARE LIMITLESS

EMAAR

The World of Tomorrow

Dubai Creek Harbour is at the heart of our bold new vision for Dubai. The eight square kilometre waterfront destination is bound to push the frontiers of architecture, design and the quality of life.

Residents of Dubai Creek Harbour enjoy close proximity to:



10 Mins From
Burj Khalifa



Wildlife Sanctuary
Home Of Pink Flamingos



15 Mins From
Dubai Int'l Airport



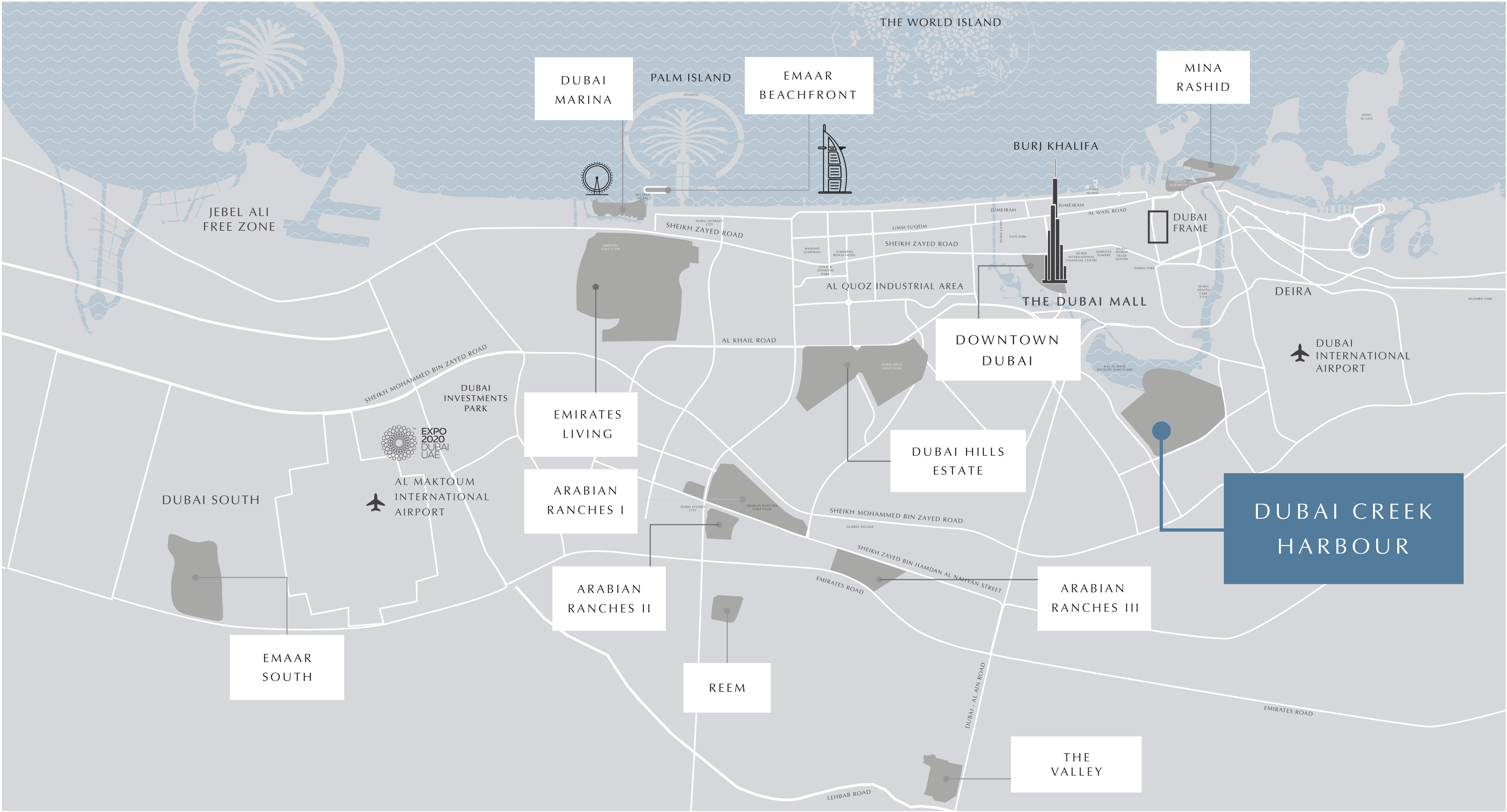

DUBAI MARINA

EMAAR BEACHFRONT

MINA RASHID

JEBEL ALI FREE ZONE

BURJ KHALIFA

DUBAI FRAME

THE DUBAI MALL

DEIRA

DUBAI INTERNATIONAL AIRPORT

DOWNTOWN DUBAI

EMIRATES LIVING

DUBAI HILLS ESTATE

DUBAI CREEK HARBOUR

ARABIAN RANCHES I

DUBAI SOUTH

AL MAKTOUM INTERNATIONAL AIRPORT

ARABIAN RANCHES II

ARABIAN RANCHES III

EMAAR SOUTH

REEM

THE VALLEY

THE WORLD ISLAND

PALM ISLAND

EMAAR BEACHFRONT

MINA RASHID

SHEIKH ZAYED ROAD

SHEIKH ZAYED ROAD

AL QUOZ INDUSTRIAL AREA

AL KHALIL ROAD

DOWNTOWN DUBAI

SHEIKH MOHAMMED BIN ZAYED ROAD

DUBAI INVESTMENTS PARK

DUBAI HILLS ESTATE

SHEIKH MOHAMMED BIN ZAYED ROAD

SHEIKH ZAYED BIN HAMDAN AL NAHYAN STREET

EMIRATES ROAD

ARABIAN RANCHES II

ARABIAN RANCHES III

EMAAR SOUTH

REEM

THE VALLEY

EMIRATES ROAD

LEHBAB ROAD

DUBAI - AL AIN ROAD



Creek Beach

Creek Beach is Dubai's first-of-its-kind urban beach in the middle of Dubai Creek Harbour. Located along the historic Dubai Creek.

Creek Beach is conceived to afford you the ultimate family-friendly retreat. From 700 metres of pristine white sands to the infinity pool and spectacular sunset views, this is paradise reborn.



Coastal Relaxation

A stylish residential cluster with three buildings rising around an inner plaza buzzing with life, Rosewater offers an expansive selection of one to four-bedroom apartments. Every residence enjoys floor-to-ceiling windows and balconies that bring light and the resort-like feel of the location.

Chic penthouses crown the buildings, each boasting outstanding views from every corner.

Destination Location



700-Metre Beach



Breathtaking Sunset Views



5 Min From Creek Marina Yacht Club



Licensed Bars & Restaurants



Dining At The Waterfront Vida Hotel

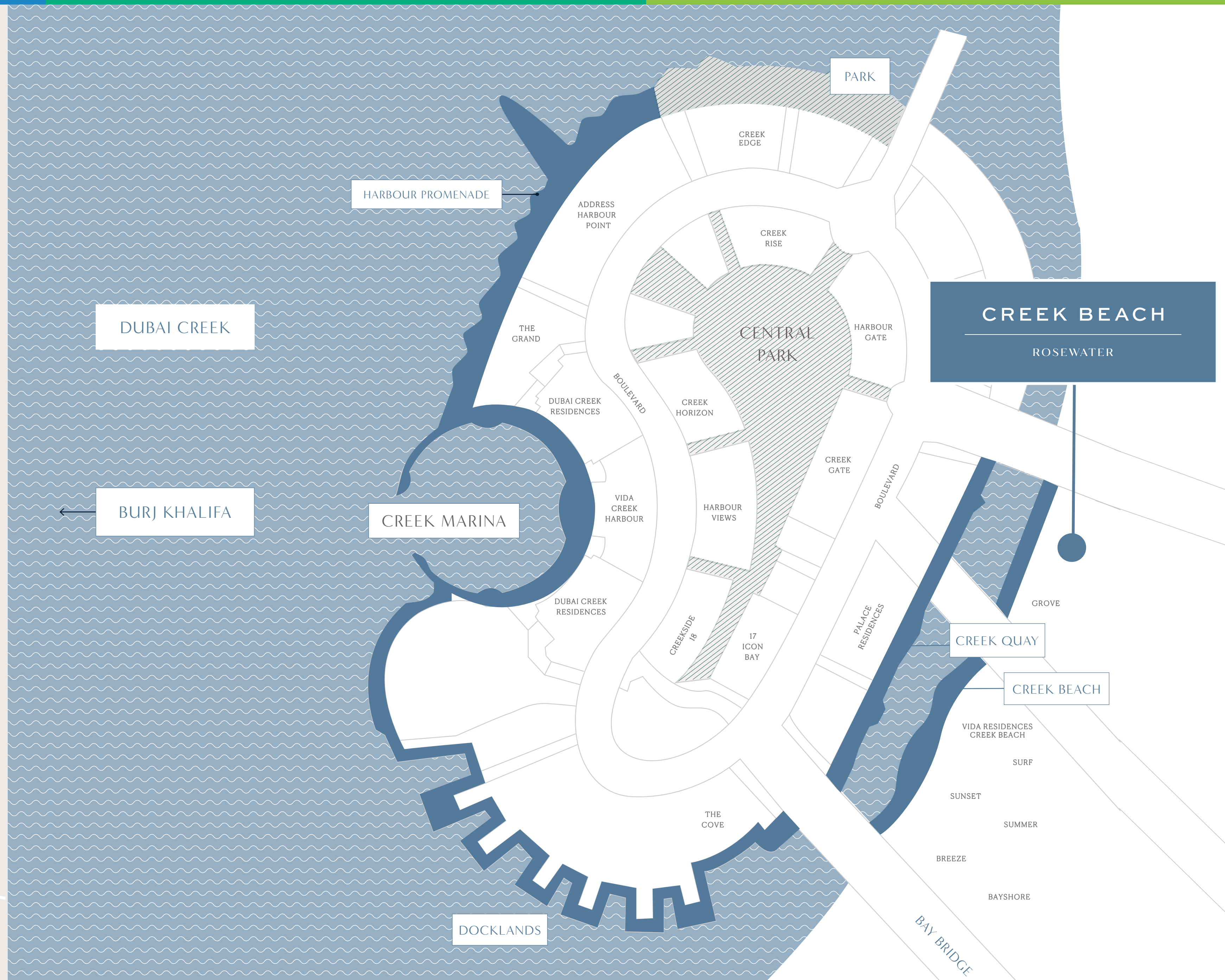

The Ideal Settings For a Bright Future





Tailored To Your Lifestyle

Structural quality, contemporary design, and elegant interiors with superb finishes harmoniously balance at Rosewater's buildings, each with a different façade, to resonate with those who appreciate the sophisticated urban lifestyle of the waterfront.

An elegant communal inner plaza, and views towards a 700-meter pristine beach, which is only a short stroll away, complement light-filled living rooms, bedrooms and balconies.

Contemporary Vibes

At Rosewater, impeccable interior planning maximises the space and light of each residence, complemented by the highest-spec details for a contemporary vibe of understated luxury tailored to the discerning buyer's tastes.



Perfectly Connected

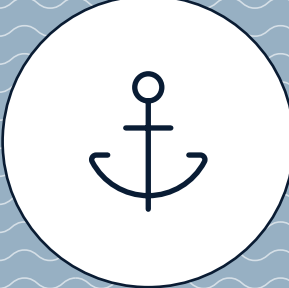

Creek Marina

Pedestrian Bridge



ROSEWATER
AT CREEK BEACH



Dedicated Metro

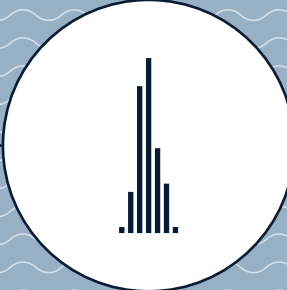

Burj Khalifa

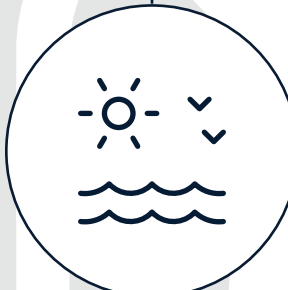

Creek Beach



Ras Al Khor Wildlife Sanctuary

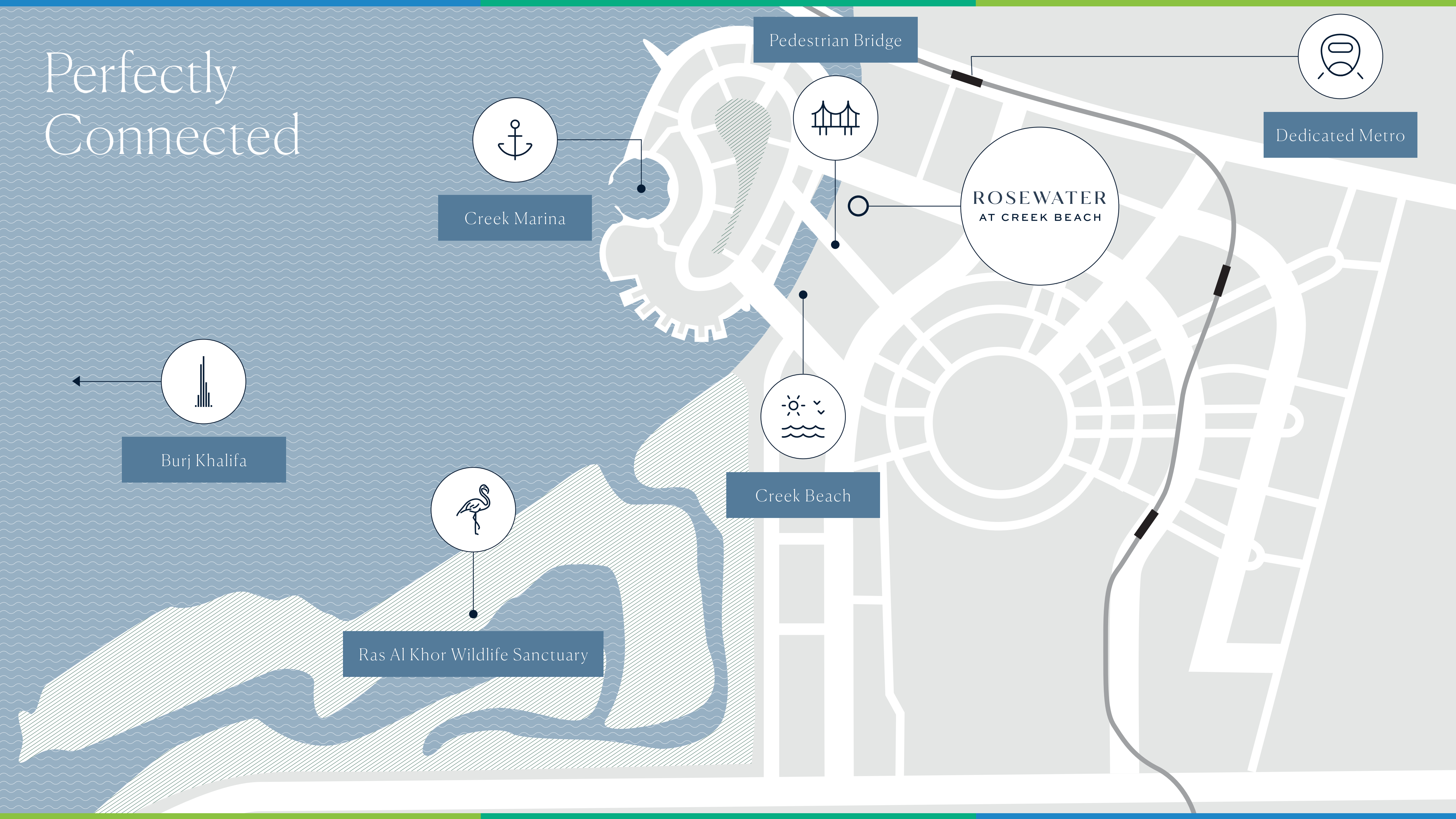

Understated Luxury

The sophisticated feel of the contemporary residence creates the distinctive character of Rosewood with a minimalist aesthetic.

Find your future home in a one, two or three-bedroom residence overlooking courtyards and greenery for the ideal getaway. Or opt for a luxurious four-bedroom penthouse with direct waterfront canal views.





Penthouse Chic

Each of Rosewater residential buildings is crowned with an ultra-chic penthouse with lightfilled living rooms, spacious bedrooms, impressive views over the creek canal and the promise of unforgettable moments of relaxation.



At the Centre of
A Waterfront Paradise

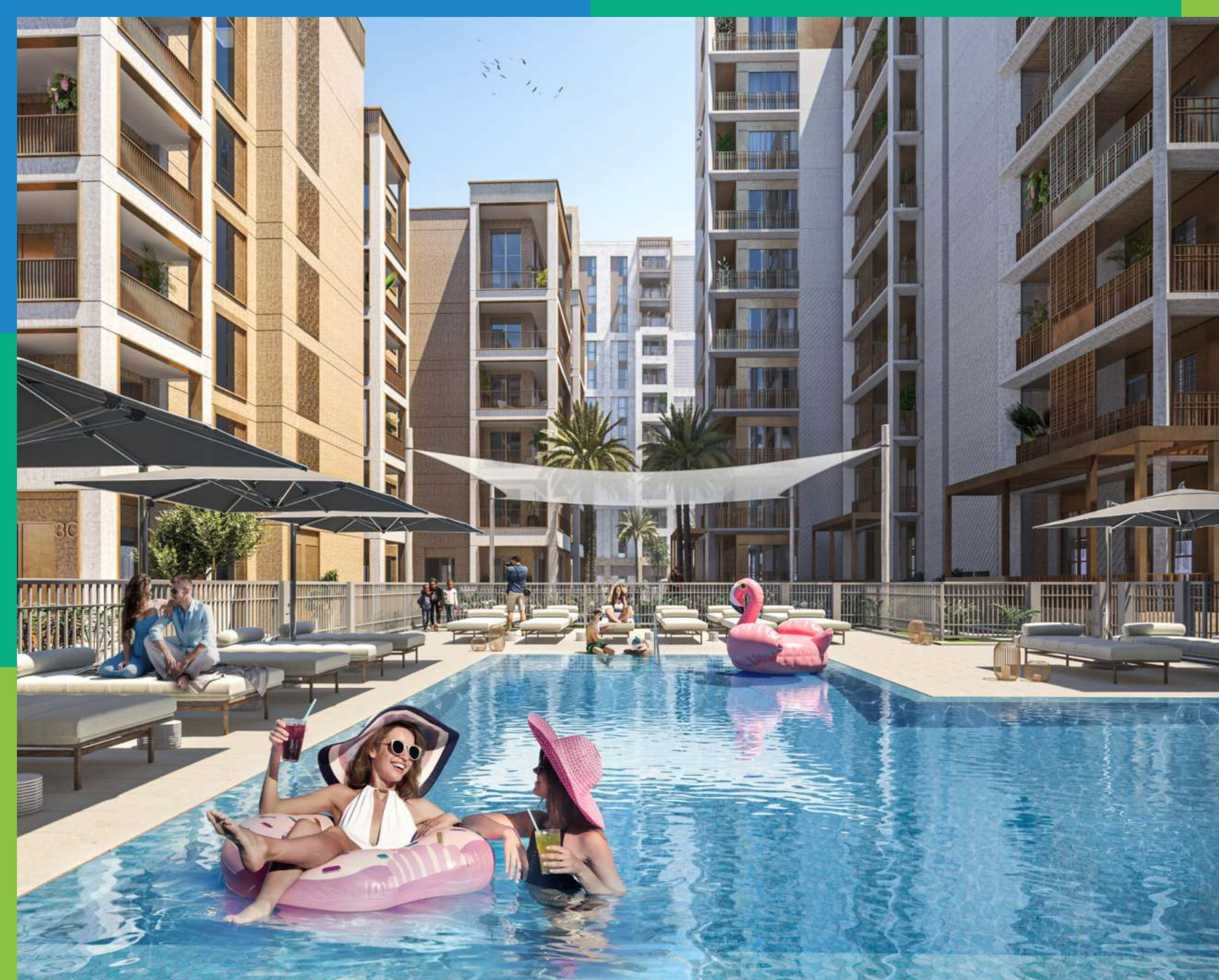

Unmatched Amenities

An unrivalled lifestyle awaits you at Rosewater, with a range of amenities and places to rejuvenate, escape, relax and socialize. Indulge in an active lifestyle with two neighbourhood plazas, a private swimming pool, a town centre with shops and restaurants, a gym on a private patio, an outdoor play area, a communal room, a barbecue area, and a lush lawn.

- COMMUNITY POOL & KIDS POOL
- BARBECUE FACILITIES
- FULLY-EQUIPPED GYM
- EXPANSIVE OUTDOOR PLAY AREA
- MULTI-PURPOSE COMMUNITY ROOM
- RETAIL AT NEARBY
- TOWN CENTRE

An Idyllic Retreat Evoking Uniquely Modern City Vibes



Strength of Emaar

A leader in the global real estate market, EMAAR has grown over the years to become the largest real estate developer outside of China. You will be investing with one of the best-regarded brands in the world.

REVENUE
AED
28.27BN

MARKET CAP
AED
40BN
AS OF 31
DECEMBER 2021

NET PROFIT
AED
3.8BN

**RESIDENTIAL UNITS
DELIVERED**
81,600+

**UNITS UNDER
CONSTRUCTION**
35,200+



CREEK BEACH

ROSEWATER

FOR MORE INFORMATION PLEASE CONTACT

AFS
REAL ESTATE
STAY AHEAD, INVEST SMART

📞 +971 55 476 7630
☎️ +971 4 368 7878
✉️ info@afsrealestate.com
🌐 www.afsrealestate.com

db
DUBRICKS
POSSIBILITIES ARE LIMITLESS

📞 +971 50 674 2020
☎️ +971 4 368 7878
✉️ info@dubricks.com
🌐 www.dubricks.com